



User's Manual for Hotel Safe

Read all instructions before using this safe.

WARNING

Warning
Test and make sure the safe works properly before mounting. Once tested, mount the safe before use.

NOTE
Barska is not responsible for any installation damages and any lost or stolen contents.

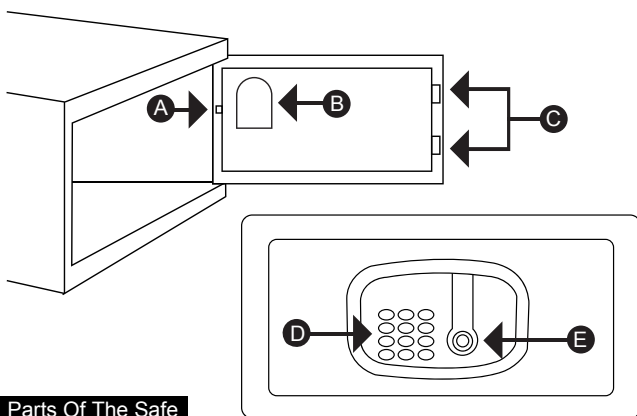

Parts Of The Safe

- A. LED Light
 - B. Battery Compartment
 - C. Bolts
 - D. Keypad
 - E. Emergency Key & USB Port Access
- * Actual model may vary

Getting Started

1. Remove all accessories that come with safe.
2. Open safe door and remove the battery cover.
3. Insert 4 AA batteries, pay attention to the polarity of the batteries and put the battery cover into place.

Note
Do not mix new and old batteries. Do not use rechargeable batteries or any other type of non-alkaline battery

Override Key

To unlock the safe using override key, remove the override key cover, insert the keys and turn counter clockwise to retract the bolt. The safe will be unlocked. Test the override keys and store the keys properly. Please note do not store the override key inside the safe.

Lock And Unlock Safe

Close
Enter 3-6 digit code, press LOCK button.

Open
Enter registered 3-6 digit code

Troubleshooting

1. ERROR Code shows on the display

Display	Solution
ERROR The code you have entered is not correct when opening or the code is not the number of digits required according to the Safe Parameters setting when locking.	Check the code and re-enter
ERROR 1 The locking bolts are blocked and cannot retract.	Push the door inward to release the blocked bolts. Try to open the safe by re-entering the code.
ERROR 2 The door is not shut properly and the bolts have been retracted automatically.	Remove the barrier and try it again.

2. Battery Condition—BA-HI/LO (Battery high/low)
Press any number on keypad and "LOCK" to check the battery condition.
The display shows "BA-HI", the battery condition is still good to use.
The display shows "BA-LO", the batteries need to be replaced. Use 4 AA alkaline batteries only.

Care and Maintenance

- Keep liquids away from the control panel. Spills on the control panel will cause damage and possibly electric shock
- Secure safe in a proper area to prevent from falling and causing damage or injury
- DO NOT disassemble the product. For all repairs, contact BARSKA Customer Service
- DO NOT use chemicals or cleaning agents to clean the safe

Mounting Instructions

The safe may be mounted to a wall or floor. Be aware of load bearing. Failure to do so can result in personal injury and/or damage to property. Use appropriate tools when performing work and always use eye protection.

Wall Mounting

- Do not mount the safe without anchoring to the wall
- Find the studs in the wall, at your desired location. Most studs are 16 inches or 24 inches apart.
 - Drill the appropriate size holes for the anchors you are using
 - Carefully press the anchor into the holes at this time
 - Mount the safe by running screws from inside of the safe and securing to anchors; ensure the safe is mounted securely

Floor Mounting

- Use proper drill tools depending on the type of floor you are mounting the safe (wood, tile, or concrete)
- Measure the location of the pre-set drill holes; mark their exact position onto the floor
- Drill the appropriate size holes for the anchors you are using
- Carefully press the anchor into the holes at this time
- Mount the safe by running screws from inside of the safe and securing to anchors; ensure the safe is mounted securely

1 YEAR LIMITED WARRANTY

SAFE/LOCK BOX

BARSKA warrants this new safe/lock box to be free of defects in material and/ or workmanship under normal use for a period of twelve (12) months from the date product is purchased. This limited warranty is delimited to repair or replacement only. This warranty does not cover damage caused by improper installation or maintenance. BARSKA disclaims all liability for incidental or consequential damages resulting from misuse, abuse, accident (such as dropping), fire, flood, service or repairs other than those performed by BARSKA, acts of nature, or arising out of any breach of this warranty. Altering the product under any circumstances will automatically void the warranty.

For service under this limited warranty, please have available the proof of purchase and the purchase date and location as well as a detailed description of the problem. This warranty is not transferable and only applies to the original purchaser with a proof of purchase from BARSKA or from an authorized dealer. This warranty applies only to products purchased within the United States, excluding Alaska, the Hawaiian Islands and all U.S. territories in the Caribbean and the Pacific.

BARSKA will examine and go through troubleshooting procedures, product repair or replacement of defective part(s) or units with new part(s) or provide a new unit, if necessary, during the warranty period. Reasonable shipping/handling charges may apply and are based on Barska sole discretion. Purchaser shall be required to prepay Shipping/handling charges with a check or money order to BARSKA at time product is returned. The Return Merchandise Authorization Number (RMA#) and shipping/handling charge MUST be obtained from BARSKA in advance of return. BARSKA shall not be liable for damages or loss occurring during shipping. Please visit via www.barska.com or call 909.445.8168 to obtain the RMA#, Shipping/handling amount, and for more information.

BARSKA reserves the right to modify or discontinue, without prior notice to the purchaser, any model or style of the product. BARSKA will determine, at its sole discretion, whether a product will be repaired or replaced. BARSKA reserves the right to discontinue or change any feature of its products at any time. If an exact replacement or product is not available, BARSKA reserves the right to provide a part or product that matches as closely as possible.

LIMITATION OF REMEDIES

BARSKA disclaims any warranties, express or implied, whether of merchantability or fitness for a particular use, except as expressly set forth herein. The sole obligation of BARSKA under this limited warranty shall be to repair or replace the covered product, in accordance with the terms set forth herein. BARSKA expressly disclaims any lost profits, general, special, indirect or consequential damages which may result from breach of any warranty, or arising out of the use or inability to use any BARSKA product. Any warranties which are implied and which cannot be disclaimed shall be limited in duration to a term of one year from the date of original retail purchase.

Some states do not allow the exclusion or limitation of incidental or consequential damages or limitation on how long an implied warranty lasts, so the above limitations and exclusions may not apply to you.

BARSKA
855 Towne Center Drive, Pomona, CA 91767