

1 YEAR LIMITED WARRANTY

SAFES

BARSKA warrants this new safe to be free of original defects in material and/or workmanship under normal use for a period of twelve (12) months from the date product is received by purchaser. This warranty does not include damage caused by improper installation or maintenance. Damage from misuse, abuse, accident (such as dropping), fire, flood, or acts of nature. Damage from service or repairs other than those performed by BARSKA. Labor, cost and shipping charges for the removal and replacement of defective parts beyond the initial twelve-month warranty period. All transportation and shipping charges. Removing or altering the seal under any circumstances will automatically void the warranty.

This warranty is limited to original purchaser and is not transferable. This warranty applies only to products purchased in the United States.

Please email info@barska.com or call 1.888.666.6769 for Return Merchandise Number (RMA#) before any returns. The RMA number must appear on the outside of the shipping package. Product must be packed carefully and sturdily in its original packaging to prevent damage in transit and returned freight pre-paid to:

BARSKA OPTICS
Repair Department
855 Towne Center Drive
Pomona, CA 91767

Please include all of the following when returning BARSKA products for service and/or replacement:

1. Please write your complete details (Name, Address, Telephone #, E-mail address, RMA#, etc.)
 2. Purchase receipt or Proof of Purchase. (Original/Copy)
 3. A brief explanation of the defect.
 4. A Check/Money Order of \$50.00 to cover inspection, shipping and handling.
- *Please allow 6-8 weeks for delivery.

BARSKA will examine and test returned product and repair or replace defective part(s) or units with new part(s) or a new unit if necessary within the warranty period. Purchaser is required to remit \$50.00 to BARSKA for return shipping and handling at time product is returned.

If repair is required after warranty period expiration, purchaser will be charged for replacement parts and return shipping.

BARSKA® shall not be liable for any consequential, incidental and/or contingent damages whatsoever. We will not pay shipping, insurance or transportation charges from you to us, or any import fees, duties and or taxes. This warranty supersedes all previous BARSKA warranties.



Biometric Safe Manual

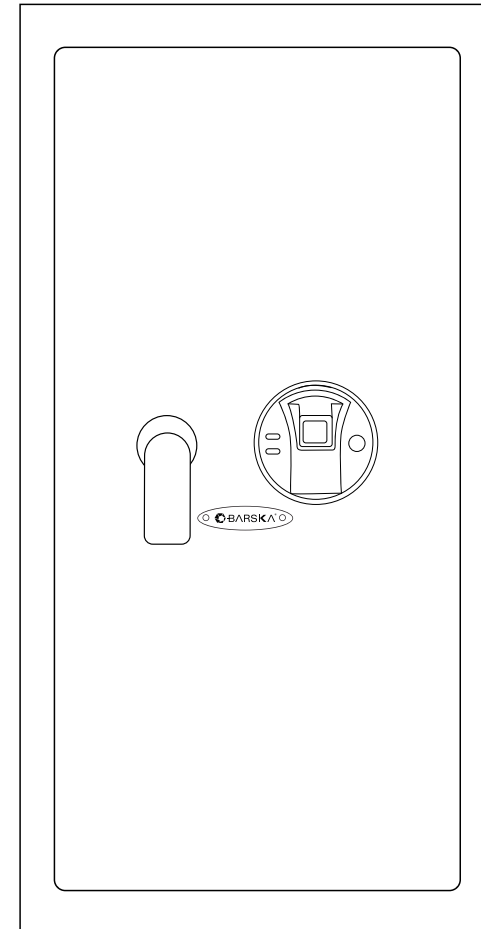

Read all instructions before using this safe

WARNING

- New Safe is in Factory Default mode; ANY fingerprint can open the safe. Only a successfully registered Fingerprint(s) can terminate Factory Default mode.
- Register at least two different fingerprints and test a few times before closing the safe door.
- Test with a non-registered fingerprint. If the safe opens, the safe is still in Factory Default mode.
- Avoid leaving safe door open and unattended; it will allow unauthorized individuals to add their fingerprints and/or reprogram the safe, gaining full access to the safe and the contents.
- Test the Emergency Keys and store them in a secure place, NOT inside of the safe.
- To maximize the security and performance of the safe, test registered fingerprints every 6 months.
- If user resets the safe to Factory Default mode: ANY fingerprint can open the safe.
- Test and make sure the safe works properly before mounting. Once tested, mount safe before use.
- Keep out of reach of children.
- Failure to follow these warnings could result in serious injury or death.

NOTE: BARSKA is not responsible for any damage or lost contents in the safe due to moisture.

NOTE: BARSKA is not responsible if the safe is stolen or contents in the safe.

Table Of Contents	
Parts Of The Safe	4
Getting Started	5
Install Batteries	5
Fingerprint Registration	5
Test Non Registered Fingerprints	6
Interior Light	6
Close/Open Safe Door	6
Close/Open Interior Compartment	6
Beep Sound Options	7
Open Safe With Emergency Key	7
Delete All Stored Fingerprints / Reset to Factory Default Mode	7
Low Battery Warning	8
Care And Maintenance	8
Mounting Instructions	9
Warranty	10

Parts of the Safe

Exterior

- A. Handle
- B. Logo Plate and Emergency Key Access
- C. Fingerprint Scanner
- D. Indicator Lights
- E. External Battery Access
- F. Wake-Up Button

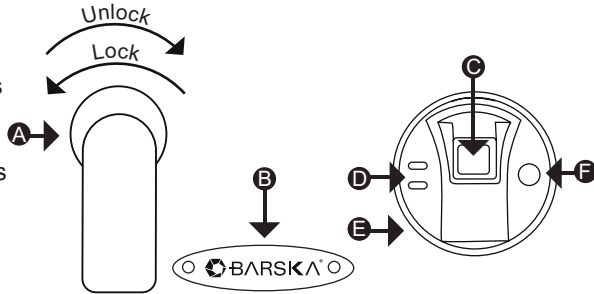

Interior

- G. Initialization Button
- H. Battery Compartment
- I. Bolts
- J. Interior Compartment
- K. Interior Lock
- L. Fold-Down Shelf
- M. Removable Shelf
- N. Interior Light Button
- O. Fold-Down Shelf Holder
- P. Interior Light
- Q. Interior Light Battery Compartment

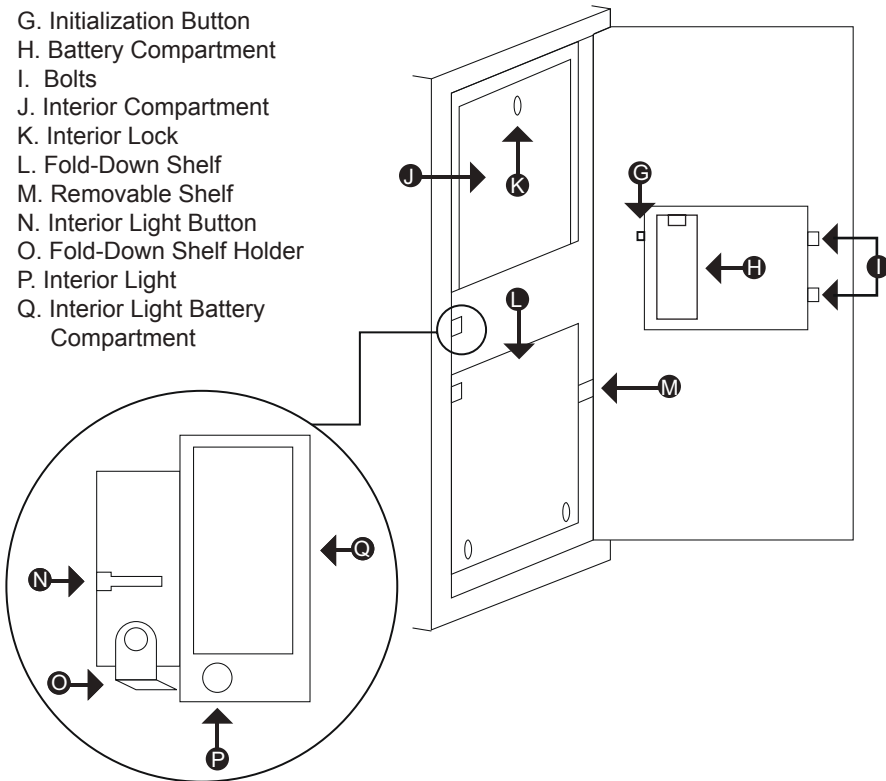

Getting Started

1. Remove Emergency Keys from accessory package
2. To expose the Emergency Key Access (B), remove Logo Plate (B) screws with provided tool
3. Check lock number and find correct emergency key, insert into key access, push and turn counter-clockwise
4. Turn Handle (A) clockwise to open the safe
5. Continue with INSTALL BATTERIES

Install Batteries

1. Remove Battery Compartment (H) cover
2. Insert 4 AA batteries and restore Battery Compartment (H) cover
3. Continue with FINGERPRINT REGISTRATION

Fingerprint Registration

IMPORTANT: The safe is in Factory Default mode, ANY fingerprint(s) can open the safe

1. With the safe door open, press and release Initialization Button (G)
2. Immediately place a finger on the Fingerprint Scanner (C)
 - Hold finger still
 - 1 beep will be heard recognizing the fingerprint; followed by 2 consecutive beeps
 - Remove finger
 - Registration is complete

Successful Registration

Registration is successful when a total of 3 beeps are heard

Unsuccessful Registration

2 short beeps will be heard; repeat registration process again

3. To register another fingerprint - repeat steps 1 – 2
4. Continue with TEST (NON) REGISTERED FINGERPRINTS

Test Non Registered Fingerprints

1. Test multiple Non-Registered fingerprints
 - With safe door open turn Handle (A) counter-clockwise to extend the Bolts (I)
 - Press and release Wake-Up Button (F)
 - Place a non-registered finger on the Fingerprint Scanner (C)
 - Red Indicator Lights (D) will flash and beep three times
 - Turn Handle (A) clockwise, the Bolts (I) should not retract
 - If the Bolts (I) retract with a non-registered fingerprint, registration was unsuccessful; the safe is still in Factory Default mode
 - Repeat steps under FINGERPRINT REGISTRATION, and test multiple non-registered fingerprints
2. Test a Registered fingerprint
 - With safe door open turn Handle (A) counter-clockwise to extend the Bolts (I)
 - Press and release Wake-Up Button (F)
 - Place a registered finger on the Fingerprint Scanner (C)
 - The indicator will turn Green and a beep will be heard
 - Turn the Handle (A) clockwise, the Bolts (I) should retract
 - Note: You have 5 seconds to turn the Handle (A)
 - Registration was successful, if it only opened with registered fingerprint(s)

Interior Light

1. Remove Interior Light Battery Compartment Cover (Q)
2. Insert 2 AA batteries and restore Interior Light Battery Compartment Cover (Q)
3. To turn the Interior Light (P)
 - On: Fold-Down Shelf (L), down position
 - Off: Fold-Down Shelf (L), up position

Close/Open Safe Door

CLOSE: Close safe door, turn Handle (A) counter-clockwise to lock the safe

OPEN: Press and release Wake-Up Button (F)

- Place a registered finger on Fingerprint Scanner (C)
- Turn Handle (A) clockwise to open the safe

Note: The indicator will turn Green and a beep will be heard; if the Red indicator light flash and beep three times, try again.

Close/Open Interior Compartment

Use the key that corresponds to Interior Compartment (J)

Open: turn Interior Lock (K) counter-clockwise

Close: turn Interior Lock (K) clockwise

Beep Sound Options

Beep OFF: Press and HOLD the Initialization Button (G) (20 - 30 seconds) until the Indicator Lights (D) flash green once

- RELEASE the Initialization Button (G)

Beep ON: Press and HOLD the Initialization Button (G) (20 - 30 seconds) until the Indicator Lights (D) flash green, followed by 1 beep

- RELEASE the Initialization Button (G)

Open Safe With Emergency Key

1. To expose the Emergency Key Access (B), remove Logo Plate (B) screws with provided tool
2. Check lock number and find correct emergency key, insert into key access, push and turn key counter clockwise and Handle (A) clockwise to open the safe

NOTE: The safe comes with 2 different locks with 2 keys

NOTE: Store Emergency Keys in a secure place, NOT inside of the safe

Delete All Stored Fingerprints / Reset to Factory Default Mode

1. Open safe, remove Battery Compartment (H) cover and all 4 AA batteries
2. Press and release Wake-Up Button (F) a few times until no beeps are heard
3. Press and HOLD the Initialization Button (G)
 - Re-insert batteries; on the 4th battery you will hear 1 beep, followed by 2 consecutive beeps indicating safe is in Factory Default mode

4. RELEASE Initialization Button (G)

5. Repeat steps 1-3 if a total of 3 beeps are not heard

6. Restore Battery Compartment cover

7. All fingerprints stored in the safe have been deleted

NOTE: The safe is in Factory Default mode, ANY fingerprint can open the safe

8. Continue with FINGERPRINT REGISTRATION and TEST (NON) REGISTERED FINGERPRINTS

Low Battery Warning

1. When the door is closed and 3 repetitive beeps are heard, and Indicator Lights (D) flash red, it indicates the batteries are low
2. Replace batteries immediately
 - Open safe, remove Battery Compartment cover and all 4 AA batteries
 - Insert 4 new AA batteries and restore Battery Compartment cover

NOTE: All registered fingerprints remain stored

Care And Maintenance

- To maximize the security and performance of the safe, keep Fingerprint Scanner (C) clean; use a dry cloth to remove any smudges or prints off the Fingerprint Scanner (C) after each use
- Test registered fingerprints every 6 months
- Keep liquids away from the control panel. Spills on the control panel will cause damage and possibly electric shock
- Secure safe in a proper area to prevent from falling and causing damage or injury
- DO NOT disassemble the product. For all repairs, contact BARSKA Customer Service
- DO NOT use chemicals or cleaning agents to clean the safe

Mounting Instructions

The safe must be mounted to a wall. Be aware of the load bearing. Failure to do so can result in personal injury and/or damage to property. Use appropriate tools when performing work and always use eye protection

1. Select the location where your wall safe will be installed. Please keep in mind that you should:
 - Choose a location that is convenient for you, but will not be easily located by others
 - Avoid exterior walls
 - Be sure to check for electric, telephone and cable TV wires, heating ducts, or plumbing. It is important to avoid all such obstructions to prevent damage to your home during installation NOTE: Barska is not responsible for any damage incurred during installation.

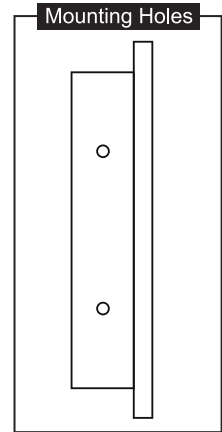

2. Locate two adjacent studs in the wall. Various stud-finders are available at your local hardware and home improvement stores.
3. Measure and cut out the wall to fit the dimensions of the wall safe. About 13.8"x 30", use a pencil to draw the cutout before actually cutting; then using a scroll saw, sabre saw or utility knife, cut out and remove the marked section of drywall.
4. Measure the cabinet and the distance between the wall studs exposed by the hole you have just cut. This will help you determine the thickness of any shims required.

NOTE: A shim is a thin, often tapered piece of wood used as filler between two materials – in this case, between the safe and wall studs. If your walls are on 16" center and the studs are of the normal 1-1/2" thickness, the shims required will be 1/4" thick. Locate the shims on either side of the opening, centering them vertically in the opening. Nail them in place. If your stud spacing or thickness is other than normal, shims of different thickness may be required.

5. Insert the safe and mark the mounting holes location on the wood, remove the safe, and drill an initial hole, put the safe back in and screw in the four screws, make sure to put all four screws in before tightening them. Ensure the safe is mounted securely.

As with any security device, your ingenuity in concealing the safe plays a large part in deterring theft. Conceal your wall safe installation appropriately. DO NOT disclose the location of the safe.