



User Manual For Fireproof Digital Keypad Safe

Read all instructions before using this safe.

WARNING

- Avoid leaving door open and unattended; it will allow unauthorized individuals to reprogram the safe, gaining full access to the safe and its contents.
- Gun Warning, do NOT storage items such as firearms, combustible materials, or medication in this unit.
- The safe can withstands heat up to 1700°F for 1 hour. The interior will reach up to 350°F. Avoid storing items such as pearls, digital media, back up tapes, data cartridge, CD's etc. These items sustain heat damage at temperatures much lower than 350°F.
- The safe has a proprietary insulation that has a high moisture content. To avoid humidity damage to contents we recommend placing a desiccant or dehumidifier inside the safe to protect the contents from rust or mildew.
- If you are storing delicate items such as jewelry, photos, etc. we recommend putting them in an air-tight container, prior to placing them in the safe for storage.
- In the event of a fire, we recommend caution when opening the safe. If you feel unsure about opening the safe because of the contents stored, contact your local fire department for assistance.
- Store emergency keys in a secure place; NOT inside of the safe.

NOTE: BARSKA is not responsible for any damage or lost contents in the safe due to moisture.

NOTE: BARSKA is not responsible if the safe is stolen or contents in the safe.

PARTS OF THE SAFE

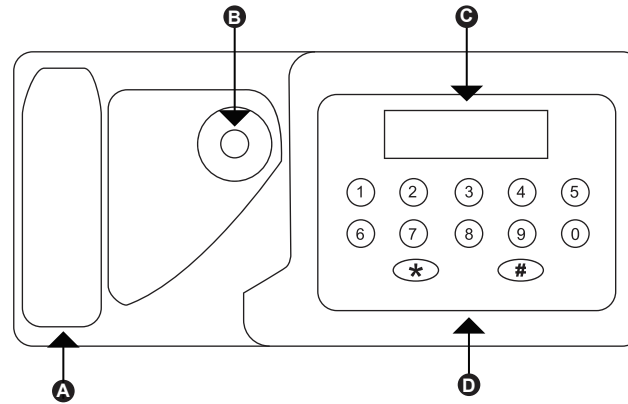

Parts of the Control Panel

- A. Handle
- B. Override Key and Cover
- C. LCD Screen
- D. Key Pad

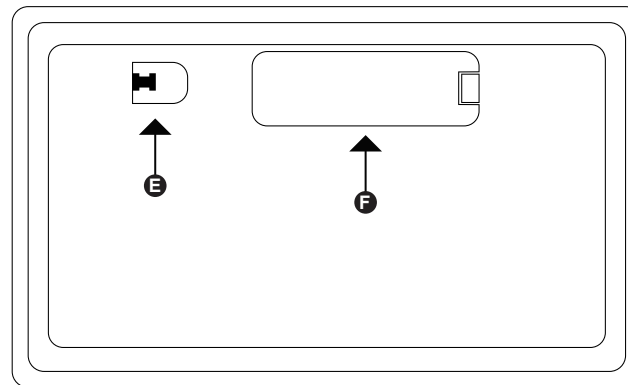

Parts of the Inside of the Safe Door

- E. Initialization Button
- F. Battery Compartment

OPENING THE SAFE WITH ACCESS KEY

1. Remove the small cover by gently pulling on it, to expose the access key slot
2. Insert the access key and turn key to the left to unlock
3. Turn handle to the right to open safe door
4. Turn access key to the right to lock, remove key and replace small plug

NOTE

Store access keys in a secure place. NOT inside of safe

BATTERIES

1. Remove battery cover on the inside of the safe door
2. Insert 4 AA batteries into the battery compartment and pay attention to the polarity of the batteries
3. Replace compartment cover

REPLACING BATTERIES

If LCD displays LO BAT, this indicates that the batteries are low.

1. Open safe by using the access key
2. Repeat steps 1-3 of "Batteries" above and replace old batteries with new batteries
3. Close safe and ensure that the safe is locked

NOTE

After reinserting batteries safe retains last personal pin codes saved

CREATING PERSONAL PIN CODES

For security purposes, change the factory default codes as soon as possible and before placing valuables in the safe.

NOTE

- 1st default pin code is 1234
- 2nd default pin code is 123456

NOTE

Safe retains only two 3-8 digit pin codes

1st Personal Pin Code

1. Open safe either by default pin codes or access key
Note: A beep will sound for each key pressed
2. Input the factory preset pin code #1234# then press * button rapidly, on the LCD screen one dash will be blinking
3. Input your personal pin code, press # to confirm the LCD screen will show ----, input digit pin code again, press # to confirm
4. "Into" appears in the LCD screen which indicates that your pin code is saved



User Manual For Fireproof Digital Keypad Safe

CREATING PERSONAL PIN CODES (continued)

2nd Personal Pin Code

For security purposes you must change the 2nd pin code set

1. Press #123456# then press * button rapidly, on the LCD screen one dash will be blinking
2. Follow steps 3 and 4 of "1st Personal Pin Code"

NOTE

Be sure to write down these codes immediately and store in a safe place

TESTING THE PERSONAL PIN CODES

1. With safe door open, and the handle in the locked position. Press # and enter in 1st set of the personal pin code on the key pad and press # again

Successful Save

- You will hear 3 short beeps
- The LCD screen will show OPEN
- Move handle to the right to retract bolts

Unsuccessful Save

- You will hear a consistent beeping
- The LCD screen will show ERROR
- Handle will not move
- Repeat steps Creating Personal Pin Codes, of 1st Personal Pin Code

2. To test 2nd personal pin code. Press # and enter in 2nd set of the personal pin code on the key pad and press # again. See "Successful Save" and "Unsuccessful Save" above
3. Close safe and ensure that the safe is locked

OPENING SAFE WITH PERSONAL PIN CODES

1. Press # then input either of the personal pin codes then press #.
2. Turn the handle to the right and pull the safe door open

NOTE

After entering pin, you have 5 seconds to turn the handle before the mechanism re-locks automatically

3. To close safe, close door and turn handle to the left to lock

RESET PERSONAL PIN CODES

1. Open safe by entering either of the personal pin codes or by using the access key
2. Press and hold down the initialization button on the inside of the safe door, release initialization button
3. On the LCD screen it will show CLEAR, indicating that the pin codes have been deleted.
4. The safe is now in default mode. Default pin codes are 1234 and 123456
5. See "Initial Numeric Pin Codes" to change default pin codes

CARE AND MAINTENANCE

- For security purposes, change the factory default codes as soon as possible
- If necessary use a damp cloth to clean the safe. DO NOT use chemicals or cleaning agents
- Keep liquids away from the control panel. Spills on the control panel will cause damage and possibly electric shock
- Secure safe in a proper area to prevent it from falling and causing damage or injury
- DO NOT over stuff the contents of the safe, it can damage the motor mechanism or the contents
- DO NOT disassemble the product. For all repairs and maintenance, contact authorized service centers or distributor BARSKA Customer Service

Replacement Keys: When calling for replacement or additional access keys have the access key code number ready. The access key code is etched on the access keys and on the access key slot.



1 YEAR LIMITED WARRANTY

SAFES

BARSKA warrants this new safe to be free of original defects in material and/or workmanship under normal use for a period of twelve (12) months from the date product is received by purchaser. This warranty does not include damage caused by improper installation or maintenance. Damage from misuse, abuse, accident (such as dropping), normal wear and tear, excessive fire, flood, or acts of nature. Damage from service or repairs other than those performed by BARSKA. Labor, cost and shipping charges for the removal and replacement of defective parts beyond the initial twelve-month warranty period. All transportation and shipping charges. Removing or altering the seal under any circumstances will automatically void the warranty.

This warranty is limited to original purchaser and is not transferable. This warranty applies only to products purchased in the United States.

Please email info@barska.com or call 1.888.666.6769 for Return Merchandise Number (RMA#) before any returns. The RMA number must appear on the outside of the shipping package. Product must be packed carefully and sturdily in its original packaging to prevent damage in transit and returned freight pre-paid to:

BARSKA OPTICS
Repair Department
855 Towne Center Drive
Pomona, CA 91767

Please include all of the following when returning BARSKA products for service and/or replacement:

1. Please write your complete details (Name, Address, Telephone #, E-mail address, RMA#, etc.)
 2. Purchase receipt or Proof of Purchase. (Original/Copy)
 3. A brief explanation of the defect.
 4. A Check/Money Order of \$50.00 to cover inspection, shipping and handling.
- *Please allow 6-8 weeks for delivery.

BARSKA will examine and test returned product and repair or replace defective part(s) or units with new part(s) or a new unit if necessary within the warranty period. Purchaser is required to remit \$50.00 to BARSKA for return shipping and handling at time product is returned. If repair is required after warranty period expiration, purchaser will be charged for replacement parts and return shipping.

BARSKA® Optics shall not be liable for any consequential, incidental and/or contingent damages whatsoever. We will not pay shipping, insurance or transportation charges from you to us, or any import fees, duties and or taxes. This warranty supersedes all previous BARSKA® Optics warranties.