

Smartphone Adapter

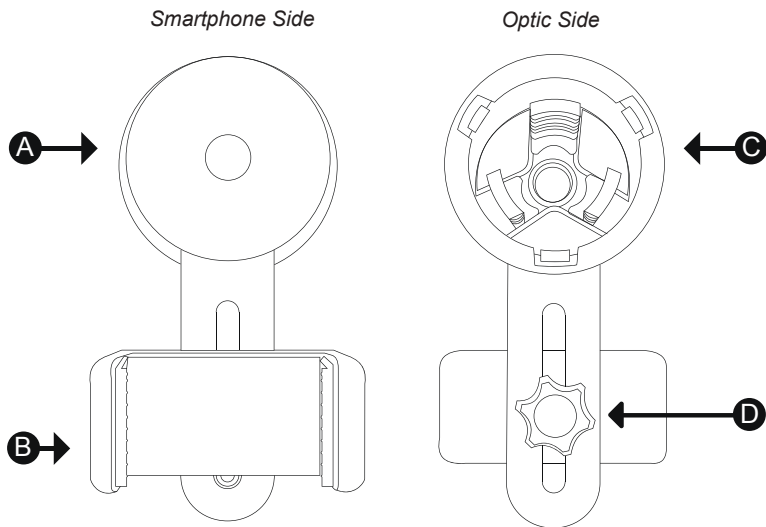

Smartphone Not Included

CAUTION: DO NOT LOOK DIRECTLY AT THE SUN. VIEWING THE SUN OR ANY LIGHT SOURCE WITH THIS OPTICAL DEVICE CAN CAUSE PERMANENT EYE DAMAGE.

Parts Of The Adaptor

- A. Smartphone Camera Cut-out C. Optic Adapter Ring
B. Smartphone Clamp D. Adjustment Screw

Mounting The Smartphone To The Adaptor

- To use the phone mount, first gently place your phone between the two clamps. If needed, you can adjust the clamps to make sure your phone is securely in place. If you have a phone case, you may need to remove it.
- Loosen the adjustment screw by turning it counterclockwise.
- Adjust the position of your phone's camera to align with the cut-out on the adaptor. Turn on your phone's camera app, making sure the flash is turned off. You should be able to see a clear image on your phone's screen.

NOTE: If your phone has multiple camera lenses, make sure you are using the correct one by checking the image on your phone's screen.

- Once everything is in place, tighten the adjustment screw by turning it clockwise until it is securely in place.

Mounting The Adaptor To The Eyepiece

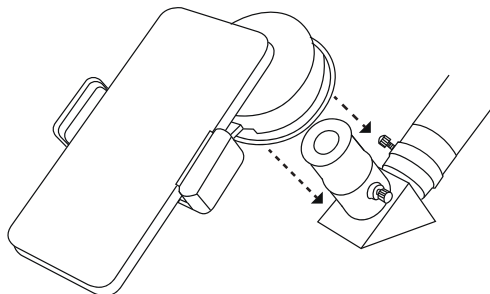

- Make sure the telescope eyepiece is securely in place by tightening the set screw to prevent it from rotating.
- Hold the adaptor with the side that goes over the eyepiece facing the telescope.
- Carefully align the adaptor over the eyepiece, then use your other hand to turn the adaptor ring counter-clockwise to secure it to the eyepiece. Be sure not to move your phone out of position.
- Make sure the adaptor is flush against the eyepiece of the telescope.
- To zoom in on the image you're seeing through the telescope, pinch the screen of your phone to enlarge the image.

Removing Smartphone From Adaptor

To remove the smartphone from the adaptor, gently pull the smartphone from between the two clamps.

Removing Adaptor From The Eyepiece

To remove the optic adaptor from the eyepiece, hold the adaptor with one hand and turn the adaptor ring clockwise with your other hand.

Safety Tips For Telescope And Phone Adaptor

This telescope is compact and lightweight so it's important to make sure all the screws are securely tightened to ensure your phone fits properly.

Never leave your phone on the telescope phone adaptor unattended. Always keep an eye on it to prevent it from falling or getting damaged.

Note: All information, feature, and specification displayed herein are based on the data available at the time of publishing, thus they are subject to change without notice. All product pictures displayed herein are for illustration purposes only. The actual product may vary due to different circumstances