

# Starwatcher Telescope Quick Set Up - 70060, 525 Power

## Parts Included

CAUTION: DO NOT LOOK DIRECTLY AT THE SUN.  
VIEWING THE SUN OR ANY LIGHT SOURCE WITH THIS  
OPTICAL DEVICE CAN CAUSE PERMANENT EYE DAMAGE.

**BARSKA**  
SINCE 1994  
VALUE. QUALITY. NEW TECHNOLOGY.



## Assembly

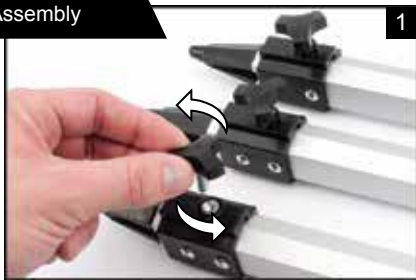

Attach (E) tripod leg screw to the extension base on each of the (P) tripod legs.



Attach each (Q) tripod leg to the (I) yolk mount using the (D) leg to yolk screw sets.

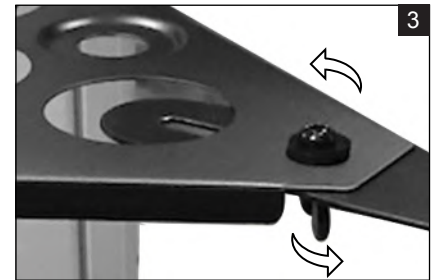

Use the (J) center leg brace screws on accessory tray (K) on each of the center leg braces to the three (P) tripod legs.



Line up the (O) main telescope optical tube with the side mount holes on the (I) yolk mount and secure in place using the two (C) optical tube screws.



Insert the (M) slow motion control rod into the hole on the (I) yolk mount. Then secure the (M) slow motion control rod with the included (N) control rod screw by tightening it with the included (F) screwdriver.



Slide (H) finderscope till it locks in place to (O) main telescope optical tube with the battery compartment and lens facing the front of the telescope.



Insert the chrome barrel of the (L) barlow lens into the focuser tube on the (O) main telescope optical tube and tighten the set screw.



Choose one (B) eyepiece and insert the Barlow Lens of the eyepiece into the (L) Barlow and tighten the set screw.

For detailed usage see included telescope manual.